



## Adapter

7370/10

Art.No. 58290010  
GTIN 4018754161034  
Model 7370/10



**Label.** Adapter Drive 9x12mm Output 14x18mm

- Features.**
- for using insert tools with an outer square drive of 14 x 18 mm on torque wrenches with an internal square drive of 9 x 12 mm
  - Caution! Modified settings on torque wrench

## Advantages.

STAHLOWILLE: For over 160 years, we as a traditional German company from Wuppertal have stood for tools that are appreciated around the world for their excellent quality

## Technologies and features.



### QuickRelease

The QuickRelease technology ensures tools cannot be inadvertently lost – while enabling rapid, safe tool changes.

## Technical Drawing.

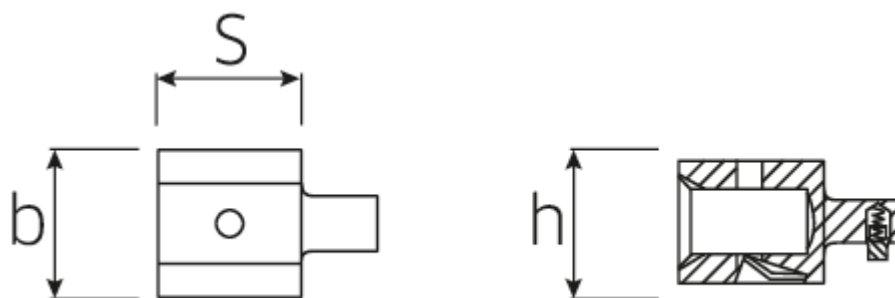

## Technical Attributes.

Output square drive inside (mm)	14x18 mm
Drive square external (mm)	9x12 mm
Width mm (b)	31 mm
Size of tool holder external square	9x12 mm
Height mm (h)	26 mm
Length mm (L)	55 mm
S	30,5 mm

## Logistics data.

Length (IFS)	55
Width (IFS)	45
Height (IFS)	27
Length (packed, mm)	55
Width (packed, mm)	45
Height (packed, mm)	27
Volume (packed, mm)	0.066825 dm <sup>3</sup>
Code	58290010
Weight (gross, kg)	0,120
Weight PAP (kg)	0,000
Weight PVC (kg)	0,002
GTIN	4018754161034
Country of origin	GERMANY
Region of origin	Nordrhein-Westfalen
WEEE/Electrical Act	nicht ear-pflichtig
Customs tariff no.	82041100
Numbers of content units per order units	1
Weight	118 g

## Variants.

Code	Article number (ERP)	Article description (Autom._)	GTIN
58290010	7370/10	Adapter Drive 9x12mm Output 14x18mm	4018754161034

## GTIN-Code.



**STAHLWILLE Eduard Wille GmbH & Co. KG**

Lindenallee 27 · 42349 Wuppertal · Germany · Phone: +49 202 4791-0 · Fax: +49 202 4791-200  
info@stahlwille.de · www.stahlwille.de · Copyright by STAHLWILLE Eduard Wille GmbH & Co. KG, Wuppertal  
Copyright by STAHLWILLE Eduard Wille GmbH & Co. KG, Wuppertal