



## Adapter

7370/40

Art.No. 58290040

GTIN 4018754161041

Model 7370/40



### Label.

Adapter Drive 14x18mm Output 9x12mm

### Features.

- for using insert tools with an outer square drive of 9 x 12 mm on torque wrenches with an internal square drive of 14 x 18 mm
- Caution! Modified settings on torque wrench

## Advantages.

STAHLWILLE: For over 160 years, we as a traditional German company from Wuppertal have stood for tools that are appreciated around the world for their excellent quality

## Technologies and features.



### QuickRelease

The QuickRelease technology ensures tools cannot be inadvertently lost – while enabling rapid, safe tool changes.

## Technical Drawing.

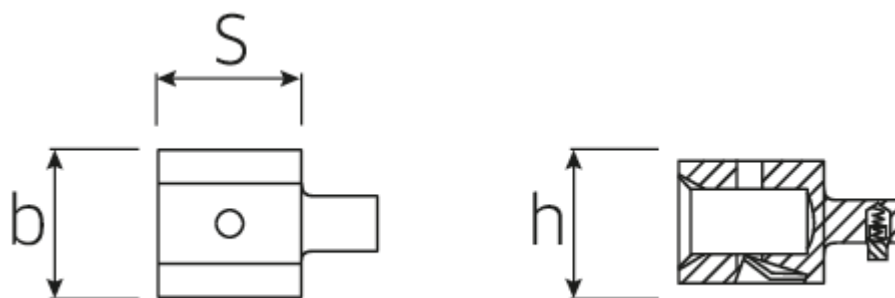

## Technical Attributes.

Output square drive inside (mm)	9x12 mm
Drive square external (mm)	14x18 mm
Width mm (b)	28 mm
Size hexagon socket [internal square]	14 x 18 mm
Height mm (h)	21 mm
Length mm (L)	60 mm
S	21,5 mm

## Logistics data.

Length (IFS)	60
Width (IFS)	45
Height (IFS)	23
Length (packed, mm)	60
Width (packed, mm)	45
Height (packed, mm)	23
Volume (packed, mm)	0.0621 dm <sup>3</sup>
Code	58290040
Weight (gross, kg)	0,120
Weight PAP (kg)	0,000
Weight PVC (kg)	0,002
GTIN	4018754161041
Country of origin	GERMANY
Region of origin	Nordrhein-Westfalen
WEEE/Electrical Act	nicht ear-pflichtig
Customs tariff no.	82041100
Numbers of content units per order units	1
Weight	117 g

## Variants.

Code	Article number (ERP)	Article description (Autom._)	GTIN
58290040	7370/40	Adapter Drive 14x18mm Output 9x12mm	4018754161041

## GTIN-Code.



**STAHLWILLE Eduard Wille GmbH & Co. KG**

Lindenallee 27 · 42349 Wuppertal · Germany · Phone: +49 202 4791-0 · Fax: +49 202 4791-200  
info@stahlwille.de · www.stahlwille.de · Copyright by STAHLWILLE Eduard Wille GmbH & Co. KG, Wuppertal  
Copyright by STAHLWILLE Eduard Wille GmbH & Co. KG, Wuppertal